

EN Instructions for use

CN Instructions for use

AR تعليمات الاستخدام

Tomme Tippee®

BORN 1965

QuickDrySteriliser



Important Warnings

These instructions can also be found at www.tommeetippee.com
Keep this instruction leaflet for future reference as it includes important information.

This appliance is intended for household use only. Do not use outdoors.

Before plugging in the Quick Dry Steriliser for the first time ensure that the voltage is compatible with your electricity supply by checking the label on the base of the unit.

Ensure water has been added to the unit before switching the unit on, when using sterilise or auto steri-dry functions.

To protect against fire, electric shock, and injury to persons; do not immerse cord, plugs, or other parts of the base of

the unit in water or other liquid. Misuse of the product may result in the risk of fire, electric shock and/or personal injury.

This appliance shall not be used by children. Keep the appliance and its cord out of reach of children. Appliances can be used by persons with reduced physical, sensory, or mental capabilities or lack of experience and knowledge if they have been given supervision or instruction concerning use of the appliance in a safe way and understand the hazards involved.

User maintenance other than cleaning and descaling is not required for this product. Cleaning and user maintenance shall not be made by children. Children shall not play with the appliance.



The heating element surface is subject to residual heat after use.

Do not touch hot surfaces, use handles and knobs, or wait for surfaces to cool before touching.

When in use the QuickDry Steriliser contains hot water and steam. Outer surfaces of the product will become hot during use. To avoid burns and scalds; keep hands away from steam vents and always allow 10 minutes after the cycle finishes before lifting the lid. Use in a well-ventilated area. Damage may occur to surfaces above steam vents, allow adequate space above vents during operation.

To prevent damage to persons and property; do not block vents.

Do not to block fan intake on bottom of base during use. Always use on a flat heat resistant surface.

Do not move appliance when in use.

To protect against fire; do not leave items covering the fan outlet or heating element, even when the unit is not in use.

Do not operate any appliance with a damaged cord, plug, or after the appliance malfunctions or has been damaged in any manner.

If the supply cord is damaged it must be changed by a qualified person in order to avoid a hazard.

Do not let the cord hang over edge of kitchen work surface or touch hot surfaces.

Do not use any accessories other than those supplied with this appliance.

Technical information

Model: WX-979A

Voltage: AC220 - 240V 50-60Hz

Sterilisation 550-650W,
Drying 370W.

Made in China.



INFORMATION ON THE DISPOSAL FOR WASTE ELECTRICAL & ELECTRONIC EQUIPMENT (WEEE)

This symbol on the products and accompanying documents means that used electrical and electronic products should not be mixed with general household waste. For proper disposal for treatment, recovery and recycling, please take these products to designated collection points where they

will be accepted on a free of charge basis. In some countries you may be able to return your products to your local retailer upon the purchase of a new product. Disposing of this product correctly will help you save valuable resources and prevent any possible effects on human health and the environment, which could otherwise arise from inappropriate waste handling. Please contact your local authority for further details of your nearest

collection point for WEEE. Penalties may be applicable for the incorrect disposal of this product in accordance with national legislation. When the time comes to dispose of this equipment, please help protect our environment by means of proper disposal. Your local authorities will have special return and disposal facilities available for you.

EN Get to know your Quick Dry Steriliser

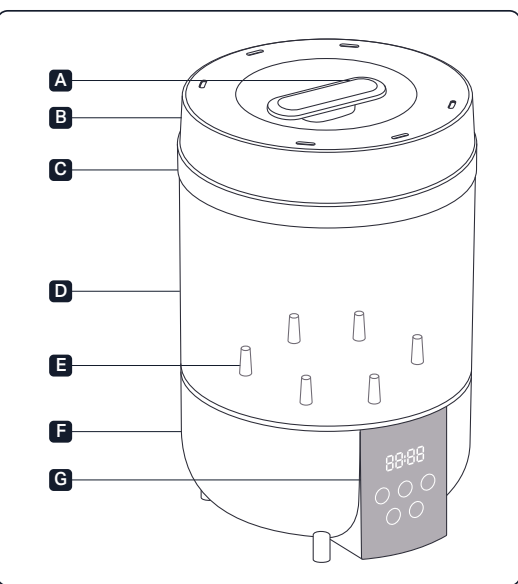

- A Grip
- B Lid
- C Upper Rack
- D Lower rack
- E Detachable small stand
- F Steriliser base
- G Control panel

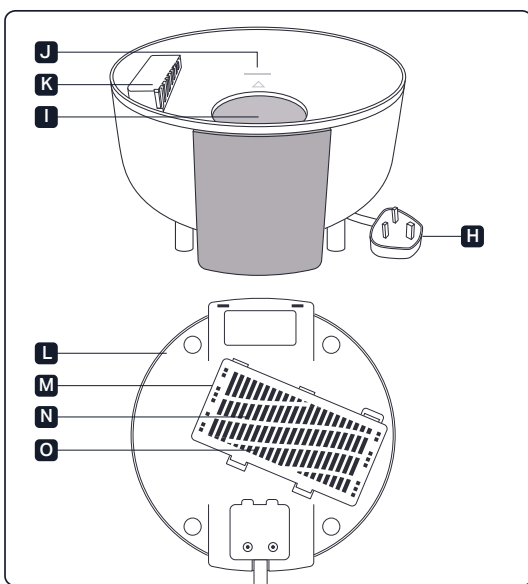

- H Lead with plug
- I Stainless steel heater surface
- J Max fill line
- K Air vent
- L Steriliser base (underside)
- M Filter panel door
- N Filter (inside door)
- O Filter tab handle (on filter)

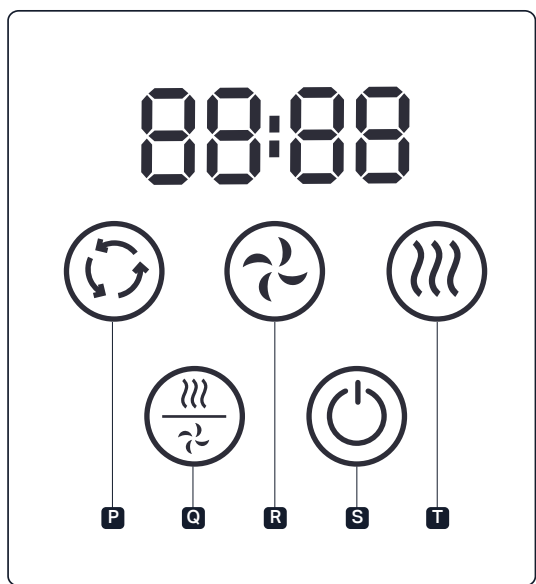

CONTROL PANEL

- P Storage
- Q Auto sterilise and dry
- R Dry
- S On / off
- T Sterilise

Setting up and using your Quick Dry Steriliser

BEFORE FIRST USE

You must insert the filter provided into the underside of the steriliser base before you start using the Quick Dry Steriliser. Please refer to the instructions on page 7.

IMPORTANT TO NOTE:

Make sure that all bottles, bottle parts, and any other accessories you want to sterilise, are washed, rinsed, and empty before using the steriliser. Excess milk in bottles can cause damage to the heater plate.

Position the steriliser on a flat surface, out of reach of children, where it can't be knocked or moved during operation.

The sterilisation and/or the drying cycle can be stopped at any time by pressing the on/off button. Once interrupted, you will have to restart the sterilising process from the beginning.

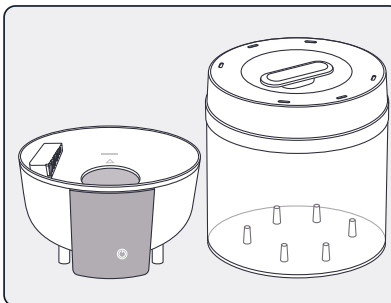

1. Remove all components from the base, including upper rack, lower rack and lid.

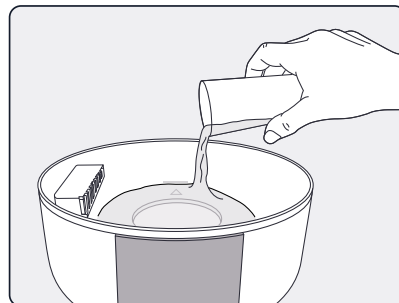

2. Pour 180ml of distilled water into the heater to the MAX fill line. We recommend using distilled water to avoid mineral scale build-up on the heating plate. However, you can use bottled or tap water, but you may need to descale more frequently.

CAUTION:

- DO NOT ADD WATER PAST THE MAX FILL LINE. FOR BEST PERFORMANCE USE THE RECOMMENDED VOLUME OF WATER.
- IF TOO LITTLE WATER IS ADDED, THE UNIT WILL CUT OFF BEFORE COMPLETING THE 8 MINUTE STERILISATION CYCLE. THE DISPLAY WILL FLASH THE REMAINING STERILISATION TIME FOR 2 MINUTES WITH BEEPS, ALERTING USERS THAT STERILISATION IS INCOMPLETE.
- THERE IS NO NEED TO ADD WATER IF YOU ARE ONLY USING THE DRYING FUNCTION.

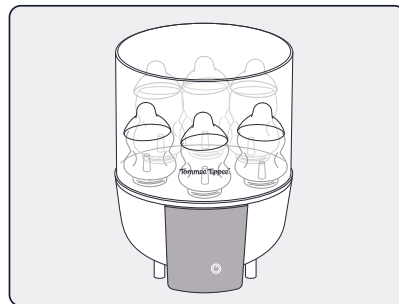

3. Place lower rack on the base and fix the small stands on to the posts of the lower rack. Place clean bottles with their opening facing downward on the small stands. Place hoods onto the bottle bases.

Setting up and using your Quick Dry Steriliser

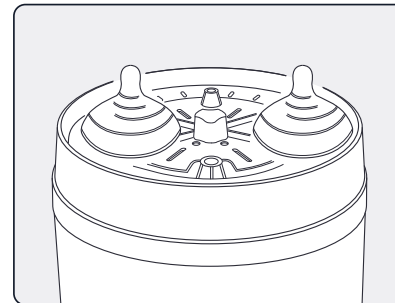

4. Place the upper rack above the lower rack. Put all accessories (eg. teat, screw ring, etc.) on the upper rack.

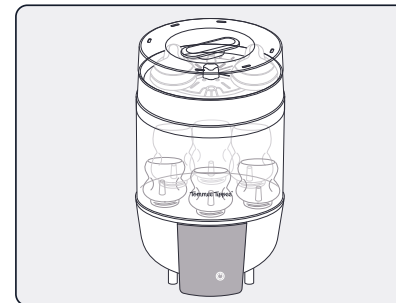

5. Place the lid on top. Double check that the lid fits securely onto the upper rack, without any gaps.

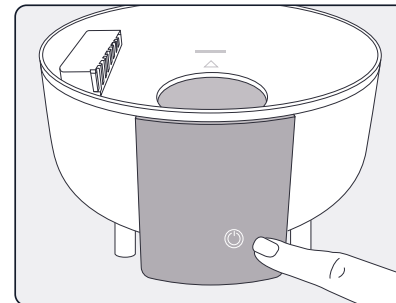

6. Plug the power cord into an electrical outlet. Your unit will audibly beep once and display the control panel LEDs. After 1 second, the display will disappear. To switch the unit on, press the ON/OFF button.

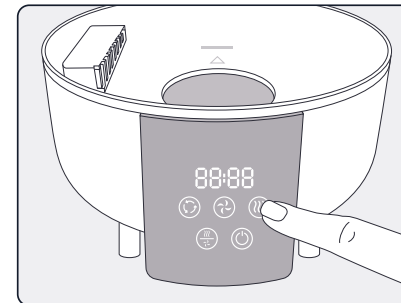

7. Select your desired function from the 4 function icon buttons. Your unit will automatically go on standby, if you don't select a new operation within 5 seconds. See 'How to use the different functions' for more information.

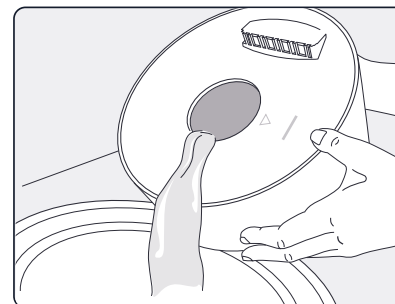

8. To drain any excess water away from the base, ALWAYS POUR SIDEWAYS, AWAY FROM THE AIR VENT.

CAUTION:
STEAM OR HOT AIR ESCAPING FROM THE UNIT CAN CAUSE BURNS. OUTER SURFACES OF THE PRODUCT WILL BECOME HOT DURING USE.
ALWAYS WAIT 10 MINUTES AFTER THE CYCLE HAS FINISHED, GIVING THE UNIT TIME TO COOL DOWN, BEFORE LIFTING THE LID.

TO ACHIEVE THE BEST STERILISATION PERFORMANCE, PLEASE ENSURE THE LOWER RACK WITH THE TOMMEE TIPPEE LOGO IS FACING THE FRONT.

How to use the different functions ✨

Sterilise



Function	Add water	Cycle duration on display
Sterilisation only	180ml	12 minutes

The appliance will start its sterilisation in 3 seconds and the display will start to countdown. Upon completion of sterilisation cycle, the unit will beep once. The button indicator will stop flashing and remain on. After 5 seconds without operation, the unit will enter into standby mode.

Dry



Repeatedly press the function button to alternate between cycle durations

Function	Add water	Cycle duration on display
Dry only	No need to add water to the heater surface	Quick drying - 14 minutes
		Standard drying - 19 minutes

The appliance will start drying in 3 seconds and the display will start to countdown. Upon completion of drying cycle, the unit will beep once. The button indicator will stop flashing and remain on. After 5 seconds without operation, the unit will enter standby mode.

Auto sterilise and dry



Repeatedly press the function button to alternate between cycle durations.

Function	Add water	Cycle duration on display
Auto	180ml	Quick Auto - 26 minutes including: natural steam in 12 minutes quick drying in 14 minutes
		Standard Auto - 28 minutes including: natural steam in 12 minutes standard drying in 16 minutes

Press the 'Auto' button again to switch between two modes: 26 minutes or 28 minutes. The appliance will start its auto cycle 3 seconds after you have selected the mode, and the display will start to countdown. There is a 40-second pause between sterilising and drying, during which the screen will be flashing. Upon completion of auto cycle, the unit will beep once. The button indicator will stop flashing and remain on. After 5 seconds without operation, the unit will enter into standby mode.

Storage



Press the 'Storage' button and the button indicator will flash. The display shows '24:00'. The appliance will start its 24 hour storage operation in 3 seconds and the display starts to countdown. The appliance will dry for 5 minutes each hour during storage mode. Upon completion of storage, the unit will beep once. The button indicator will stop flashing and remain on. After 5 seconds without operation, the unit will enter into standby mode. Users can press either 'Storage' first or after pressing 'Sterilise', 'Dry', or Auto'. The unit will complete the selected function before automatically switching to 24 hour storage mode.

CAUTION: STEAM OR HOT AIR ESCAPING FROM THE UNIT CAN CAUSE BURNS. OUTER SURFACES OF THE PRODUCT WILL BECOME HOT DURING USE.
ALWAYS WAIT 10 MINUTES AFTER THE CYCLE HAS FINISHED, GIVING THE UNIT TIME TO COOL DOWN, BEFORE LIFTING THE LID.
LET THE PRODUCT REST FOR 30 MINUTES BETWEEN EACH DRYING CYCLE TO AVOID OVERHEATING.

Cleaning your Quick Dry Steriliser ✨

Always unplug your unit and wait for it to cool before cleaning. Please be aware that the heater plate is the hottest (exposed) part of the unit.

Pour away remaining water from the steriliser base by tipping the unit sideways over a sink, to prevent any water getting into the air vent.

Wipe the unit clean with a damp cloth only.

The lid **B**, rack **C**, rack **D** and detachable small stands **E** can be cleaned in hot soapy water and rinsed well. Do not clean with abrasive cleaners.

Only lid **B**, rack **C** and detachable small stands **E** are suitable for cleaning in a dishwasher. Do not place rack **D** in the dishwasher as its large size increases the risk of deformation.

WARNING!

ALWAYS UNPLUG THE UNIT BEFORE CLEANING TO AVOID THE RISK OF ELECTRIC SHOCK, INJURY OR DAMAGE.

DO NOT IMMERSE THE BASE, THE SUPPLY CORD, OR THE PLUG IN WATER OR OTHER LIQUIDS.

DO NOT CLEAN BASE UNDER WATER TAP.

Do not use metal objects or scourers to clean the unit.

Do not use bleach or sterilising fluid to clean the unit.

Do not use abrasive or anti-bacterial materials.

Do not scrub the heat plate.

CAUTION! UNDER NO CIRCUMSTANCES USE ABRASIVE, CORROSIVE OR SCRATCHING CLEANING AGENTS, AS THESE COULD DAMAGE YOUR STERILISER.

Descaling your Quick Dry Steriliser ✨

The quality of your water will affect how often you should de-scale your steriliser.

For hard water, descale every 14 days.
For medium water, descale every 21 days.
For soft water, descale every 28 days.

You can find out your water quality from your water provider.

Unplug the unit and allow to cool, **before descaling**. Remember to pour away any remaining water from the steriliser base by tipping the unit sideways over a sink to prevent any water from entering the air vent, and wipe with a damp cloth ONLY.

Limescale may build up quicker in areas with hard water, requiring descaling sooner. You can descale when the limescale is visible. Use a descaler that is suitable for use with stainless steel and use as per the manufacturer's guidelines. Alternatively, you can use white vinegar, or a descaling sachet to descale your unit.

Where no method is stated, 50:50 descaler to water ratio can be applied.

Replacing the HEPA filter



You'll need to replace the filter every six months to maintain optimal performance.

The filter is located on the base of the unit. To replace the filter:

- 1 Remove the cover **M** by gently squeezing the latches.
- 2 Remove and replace the filter **N**, ensuring the pull tab **O** is still visible on top of the filter.
- 3 Snap the filter cover **M** back into position.

Troubleshooting



Issue	Possible cause	Solution
Unit will not start	Unit is unplugged.	Make sure the plug is securely inserted into the power outlet.
	Unit is not turned on.	Press On/Off switch before choosing function.
	Heater plate is too hot.	Let the unit cool for 10 minutes after the cycle, and double-check that the recommended volume of water has been added before restarting the unit.
Limescale on the heater plate	Hard water used persistently.	Wipe the unit clean with a damp cloth after each use. We recommend using distilled water to avoid mineral scale build-up on the heating plate. However, you can use bottled or tap water, but you may need to descale more frequently. For cleaning and descaling methods, please refer to the content on page 5.
The unit flashes the remaining sterilisation time for 2 minutes with beeps, then turns off	The recommended volume of water was not added to the heater plate. Water has boiled away before cycle completion.	Double check the correct volume of water has been added to the heater plate.
Items aren't dry after drying cycle has completed	Water is collecting on recessed or indented areas of items placed in steriliser.	Make sure parts are placed with the opening facing downwards on the upper and lower racks.